

FAIRFIELD COUNTY ENGINEER

FAI-TR289-0.132

MADISON TOWNSHIP

HOPEWELL CHURCH ROAD

ROADWAY IMPROVEMENT PROJECT

PROJECT DESCRIPTION
 UPGRADING 0.13 MILE OF HOPEWELL CHURCH ROAD, BY
 WIDENING AND RESURFACING, INCLUDING SHOULDER
 WIDENING, AND DITCH IMPROVEMENTS.

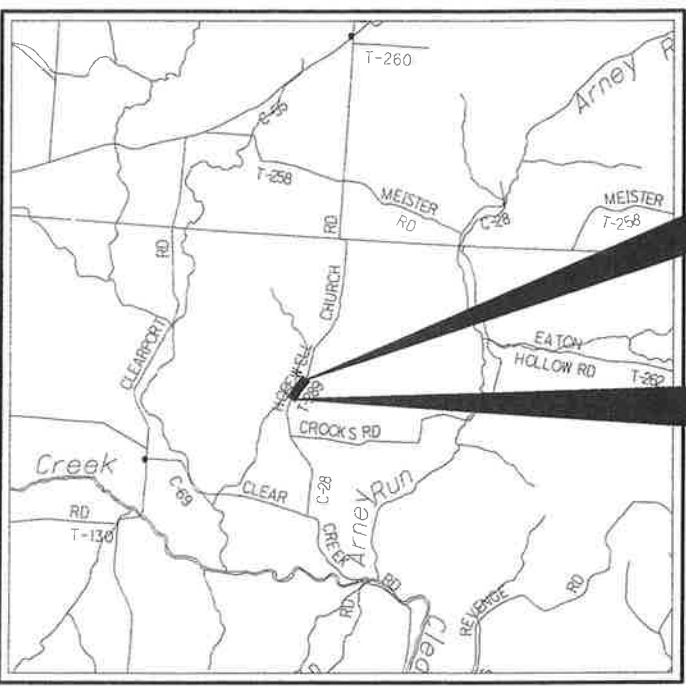

END PROJECT
 STA. 26+20.00

BEGIN PROJECT
 STA. 19+20.00

LOCATION MAP

LATITUDE: 39°37'48" LONGITUDE: 82°39'52"



PORTION TO BE IMPROVED	_____
INTERSTATE HIGHWAY	_____
FEDERAL ROUTES	_____
STATE ROUTES	_____
COUNTY & TOWNSHIP ROADS	_____
OTHER ROADS	_____

DESIGN DESIGNATION

CURRENT ADT (2025)	474
DESIGN YEAR ADT (2045)	512
DESIGN SPEED	55
LEGAL SPEED	55
DESIGN FUNCTIONAL CLASSIFICATION:	
RURAL LOCAL	

INDEX OF SHEETS

SHEET TITLE	SHEET NUMBER
TITLE SHEET	1
TYPICAL SECTIONS	2
GENERAL NOTES	3
GENERAL SUMMARY	4
SUB SUMMARY AND PAVEMENT CALCULATIONS	5
PLAN AND PROFILE	6
PLAN AND PROFILE	7
DRIVE PROFILES	8
CROSS SECTIONS	9-17

2023 SPECIFICATIONS

THE STANDARD SPECIFICATIONS OF THE STATE OF OHIO, DEPARTMENT OF TRANSPORTATION, INCLUDING CHANGES SUPPLEMENTAL SPECIFICATIONS LISTED IN THE PROPOSAL SHALL GOVERN THIS IMPROVEMENT.

I HEREBY APPROVED THESE PLANS AND DECLARE THAT THIS IMPROVEMENT WILL REQUIRE THE CLOSING OF TRAFFIC OF THE HIGHWAY.

FAIRFIELD COUNTY ENGINEER: [Signature]
 DATE: 2-10-25

WE THE TRUSTEES OF MADISON TOWNSHIP IN FORMAL SESSION, HEREBY APPROVE THESE PLANS:

TRUSTEE: [Signature]
 DATE: 2-18-25

TRUSTEE: [Signature]
 DATE: 2-18-25

TRUSTEE: _____
 DATE: _____



PLAN PREPARED BY:
 FAIRFIELD COUNTY ENGINEER'S OFFICE
 3026 W. FAIR AVENUE
 LANCASTER, OHIO 43130
 JEREMIAH D. UPP, P.E., P.S.
 FAIRFIELD COUNTY ENGINEER

ENGINEER'S SEAL:

 SIGNED: [Signature]
 DATE: 2-6-25

		STANDARD CONSTRUCTION DRAWINGS	SUPPLEMENTAL SPECIFICATIONS	SPECIAL PROVISIONS
BP-3.1	01/19/24			
BP-4.1	07/19/13			
MT-101.60	04/21/23			
DM-4.2	07/20/12			
DM-4.4	01/15/16			

OPWC DQAB03

TITLE SHEET

DESIGN AGENCY

 DESIGNER: JAA
 REVIEWER: JAA
 WGM 01/25
 PROJECT ID: TR289-0.132
 SHEET TOTAL: 1 / 17

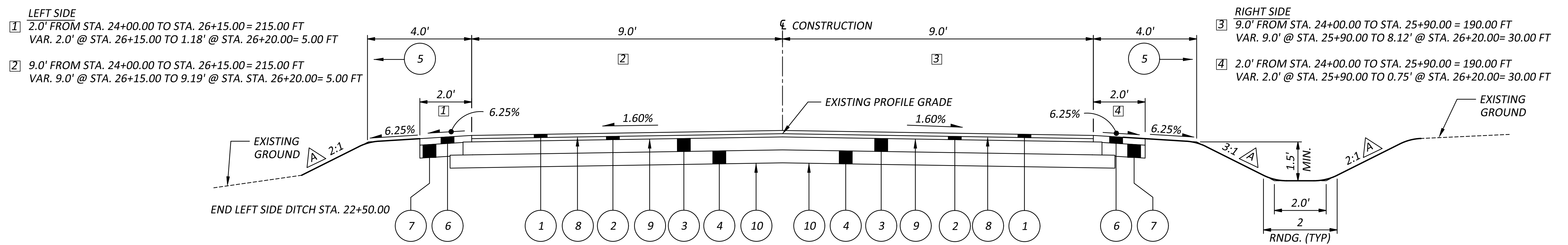

FULL DEPTH SECTION T.R.289-0.3645
SECTION APPLIES:
STA. 24+00.00 TO STA. 26+20.00 = 220.00 FT.

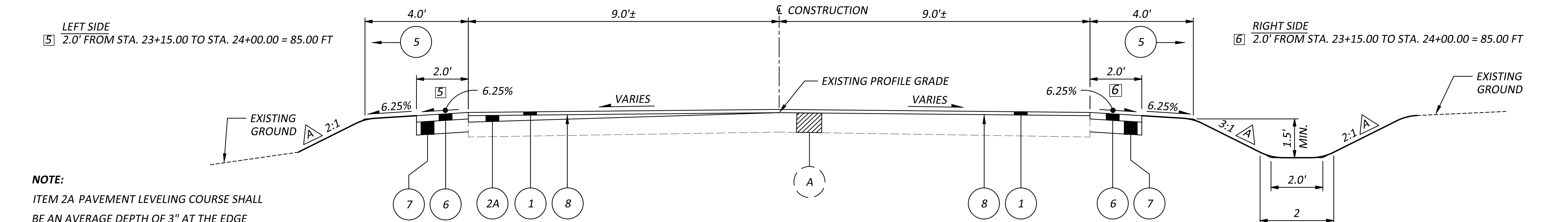

RESURFACING SECTION T.R.289-0.3645
SECTION APPLIES:
STA. 23+15.00 TO STA. 24+00.00 = 85.00 FT.

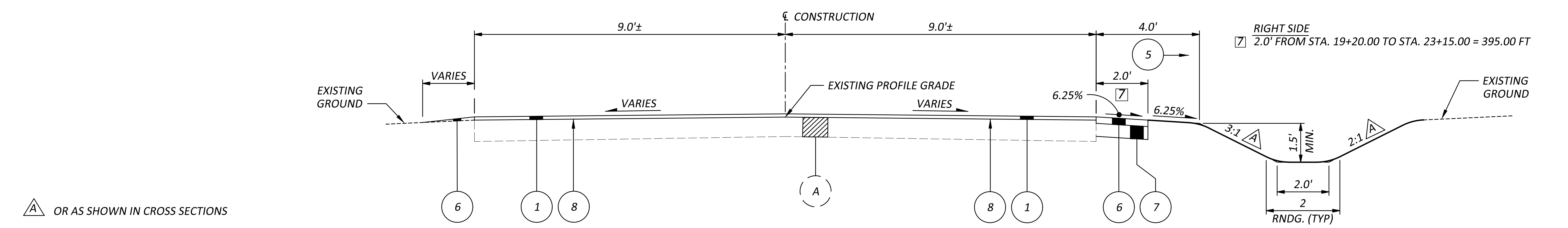

RESURFACING SECTION T.R.289-0.3645
SECTION APPLIES:
STA. 19+20.00 TO STA. 23+15.00 = 395.00 FT.

NOTE:
ITEM 2A PAVEMENT LEVELING COURSE SHALL BE AN AVERAGE DEPTH OF 3" AT THE EDGE OF EXISTING PAVEMENT TAPERING OFF TO ZERO AT THE C/L OF THE ROADWAY WITH A VARYING CROSS SLOPE THROUGHOUT.

A OR AS SHOWN IN CROSS SECTIONS

LEGEND

- 1 ITEM 441 - 1 1/2" ASPHALT CONCRETE, SURFACE COURSE, TYPE 1, PG 64-22 (449)
- 2 ITEM 441 - 1 3/4" ASPHALT CONCRETE, INTERMEDIATE COURSE, TYPE 2 (449)
- 2A ITEM 441 - VARIABLE ASPHALT CONCRETE, INTERMEDIATE COURSE, TYPE 2 (449)
- 3 ITEM 301 - 6" ASPHALT CONCRETE BASE
- 4 ITEM 304 - 6" AGGREGATE BASE
- 5 ITEM 659 - SEEDING AND MULCHING
- 6 ITEM 411 - STABILIZED CRUSHED AGGREGATE (T=3"), AS PER PLAN
- 7 ITEM 304 - 6" AGGREGATE BASE (BERM)
- 8 ITEM 407 - NON-TRACKING TACK COAT FOR INTERMEDIATE COURSE (0.05 GAL/SY)
- 9 ITEM 407 - NON-TRACKING TACK COAT FOR BASE COURSE (0.075 GAL/SY)
- 10 ITEM 204 - SUBGRADE COMPACTION
- A EXISTING ASPHALT PAVEMENT (T 12"±)

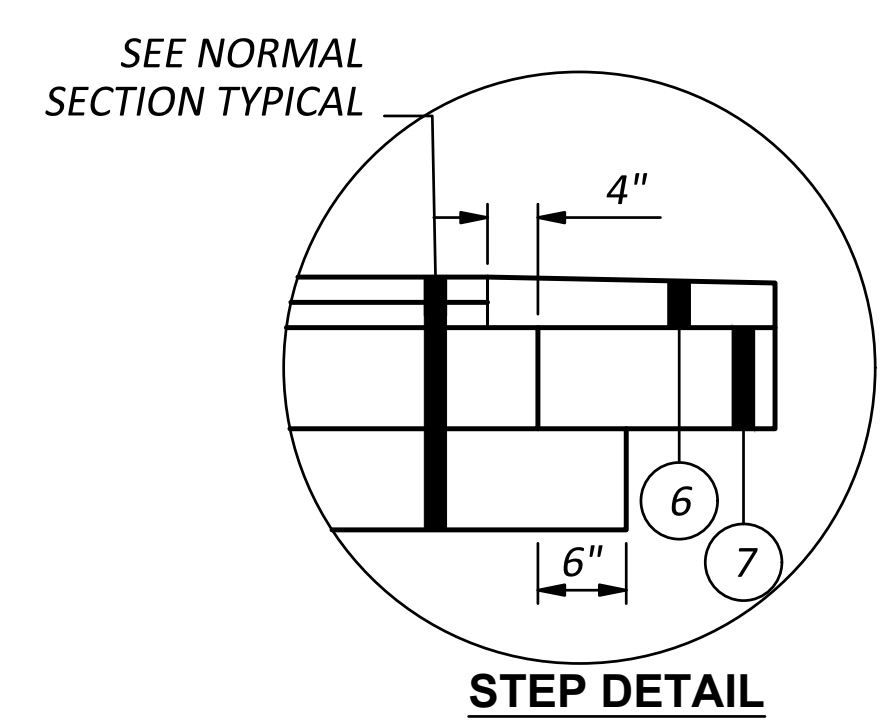

TYPICAL SECTIONS

DESIGN AGENCY
FAIRFIELD COUNTY ENGINEER

DESIGNER
JAA

REVIEWER
WGM 01/25

PROJECT ID
TR289-0.132

SHEET TOTAL
2 17

ROUNDING

THE ROUNDING AT SLOPE BREAKPOINTS SHOWN ON THE TYPICALS SECTIONS APPLIES TO ALL CROSS SECTIONS, EVEN THOUGH OTHERWISE SHOWN.

UTILITIES

IT SHALL BE THE RESPONSIBILITY OF THE CONTRACTOR TO CONTACT OUPS (800-362-2764) FOR EACH LOCATION WHERE DIGGING IS REQUIRED OR IN LOCATIONS WHERE POSTS ARE TO BE DRIVE4N. NON-MEMBER UTILITY COMPANIES MUS BE CALLED DIRECTLY BY THE CONTRACTOR.

LISTED BELOW ARE ALL UTILITIES LOCATED WITHIN THE PROJECT CONSTRUCTION LIMITS TOGETHER WITH THEIR RESPECTIVE OWNERS:

SOUTH CENTRAL POWER COMPANY ATTN: ZACHERY A. REED, P.E. DIRECTOR OF ENGINEERING 720 MILL PARK DR LANCASTER, OH 43130 O: 740-689-6150 C: 740-415-4274 zreed@southcentralpower.com	FRONTIER COMMUNICATIONS ATTN: ROBERT LATHAM 241 S. NELSON AVE. WILMINGTON, OH 45177 C: 937-708-9671 rob.latham@ftr.com
--	---

SOUTH CENTRAL POWER COMPANY ATTN: MIKE CHALFAN 720 MILL PARK DR LANCASTER, OHIO 43130 O: 740-689-6168 C: 614-563-9628 chalfan@southcentralpower.com	FRONTIER COMMUNICATIONS ATTN: TRAVIS BRANNON H: 740-381-8676 C: 740-835-6825 travis.l.brannon@ftr.com
--	---

POINT BROADBAND
 ATTN: MARK GALLOWAY
 145 COLUMBUS ROAD, SUITE 101
 ATHENS, OHIO 43701
 C: 740-648-8358
mark.galloway@point-broadband.com

THE LOCATION OF THE UNDERGROUND UTILITIES SHOWN ON THE PLANS ARE AS OBTAINED FROM THE OWNERS AS REQUIRED BY SECTION 153.64 O.R.C.

WORK LIMITS

THE WORK LIMITS SHOWN ON THE PLANS ARE FOR PHYSICAL CONSTRUCTION ONLY. PROVIDE THE INSTALLATION AND OPERATION OF ALL WORK ZONE TRAFFIC CONTROL AND WORK ZONE TRAFFIC DEVICES AS REQUIRED BY THESE PLANS WHETHER INSIDE OR OUTSIDE THESE PLANS WHETHER INSIDE OR OUTSIDE THESE WORK LIMITS.

ENGINEER DEFINED

DULY AUTHORIZED AGENT OF THE FAIRFIELD COUNTY ENGINEER ACTING WITHIN THE SCOPE OF HIS/HER AUTHORITY FOR PURPOSES OF ENGINEERING ADMINISTRATION OF THE CONTRACT.

CONTRACTOR DEFINED

THE INDIVIDUAL, FIRM OR CORPORATION CONTRACTING WITH THE FAIRFIELD COUNTY ENGINEER FOR PERFORMANCE OF PRESCRIBED WORK, ACTING DIRECTLY OR THROUGH A DULY AUTHORIZED REPRESENTATIVE AND QUALIFIED UNDER THE PROVISIONS OF 5525.02 TO 5525.09, OF THE ORC, AND ANY AMENDMENTS THERETO.

CONTINGENCY QUANTITIES

THE CONTRACTOR SHALL NOT ORDER MATERIAL OR PERFORM WORK FOR ITEMS DESIGNATED BY PLAN NOTE TO BE USED "AS DIRECTED BY THE ENGINEER" UNLESS AUTHORIZED BY THE ENGINEER.

SURVEYING PARAMETER

PRIMARY PROJECT CONTROL MONUMENTS GOVERN ALL POSITIONING ON FCEO PROJECT. SEE SHEET ___ OF THE PLANS FOR A TABLE CONTAINING PROJECT CONTROL INFORMATION.

USE THE FOLLOWING PROJECT CONTROL, VERTICAL POSITIONING, AND HORIZONTAL POSITIONING PARAMETERS FOR ALL SURVEYING:

PROJECT CONTROL:

VERTICAL POSITIONING

ORTHOMETRIC HEIGHT DATUM: NAVD88
 GEOID: GEOID12A

HORIZONTAL POSITIONING

REFERENCE FRAME: NAD83(2011)
 ELLIPSOID: GRS80
 COORDINATE SYSTEM: OHIO STATE PLANE SOUTH

USE THE POSITIONING METHODS AND MONUMENT TYPE USED IN THE ORIGINAL SURVEY TO RESTORE ALL MONUMENTS RELATED TO PRIMARY PROJECT CONTROL THAT ARE DAMAGED OR DESTROYED BY CONSTRUCTION ACTIVITIES. RESTORE THE DAMAGED OR DESTROYED MONUMENTS IN ACCORDANCE WITH CMS 623.

UNITS ARE IN U.S. SURVEY FEET.

ITEM 201 - CLEARING AND GRUBBING

ALL TREES AND STUMPS WITHIN THE CONSTRUCTION LIMITS SHALL BE REMOVED UNDER THE LUMP SUM BID FOR ITEM 201, CLEARING AND GRUBBING , EXCEPT THOSE OTHERWISE DESIGNATED BY THE ENGINEER.
 LANDOWNERS SHALL BE ALLOWED TO SALVAGE THE WOOD FROM TREES BEING REMOVED FROM THEIR PROPERTY. TREES DESIGNATED AS BEING SALVAGED FOR WOOD, SHALL BE CUT ABOVE THE BASE AND PLACED OUTSIDE OF THE RIGHT-OF-WAY.

ITEM 204 - UNSUITABLE FOUNDATION SOILS

IF UNSUITABLE FOUNDATION SOILS ARE ENCOUNTERED IN THE AREAS OF PROPOSED ROADBED OR STRUCTURES, THEY SHALL BE REMOVED AND REPLACED WITH SUITABLE MATERIAL. THE LOCATIONS AND DIMENSIONS WILL BE DETERMINED BY THE ENGINEER.

THE FOLLOWING CONSTRINGENCY QUANTIFIES HAVE BEEN INCLUDED IN THE GENERAL SUMMARY TO BE AS DIRECTED BY THE ENGINEER.

204 - EXCAVATION OF SUBGRADE	100 CY
204 - GRANULAR MATERIAL, TYPE F, APP	100 CY
204 - GEOTEXTILE FABRIC	200 SY

ITEM 204 - PROOF ROLLING, AS PER PLAN

AN ESTIMATED QUANTITY FOR THIS ITEM HAS BEEN PROVIDED IN THE GENERAL SUMMARY FOR USE AS DIRECTED BY THE ENGINEER. THE CONTRACTOR MAY UTILIZED A FULLY LOADED DUMP TRUCK, APPROVED BY THE ENGINEER, IN LIEU OF THE PROOF ROLLER REQUIREMENTS LISTED IN THE SPECIFICATION 204.06 A-G. ALL OTHER REQUIREMENTS PER 204.06 SHALL APPLY.

ITEM 204 - PROOF ROLLING	1 HR.
--------------------------	-------

ITEM 407 - NON-TRACKING TACK COAT (BASE AND INTERMEDIATE COURSE)

THE RATE OF APPLICATION OF THE 407 NON-TRACKING TACK COAT SHALL BE SUBJECT TO ADJUSTMENT AS DIRECTED BY THE ENGINEER. FOR ESTIMATING PURPOSES ONLY THE PLAN QUANTITIES INDICATE AND AVERAGE APPLICATION RATE OF:

407 - NON-TRACKING TACK COAT FOR INTERMEDIATE COURSE	0.050 GAL/SY
407 - NON-TRACKING TACK COAT FOR BASE COURSE	0.075 GAL/SY

ITEM 411 - STABILIZED CRUSHED AGGREGATE, AS PER PLAN

THE CRUSHED MATERIAL PROVIDED FOR THIS ITEM SHALL BE CRUSHED LIMESTONE.

ITEM 441 - ASPHALT CONCRETE

THE HOT MIX ASPHALT MIXTURE SHALL BE COMPOSED OF AGGREGATE, ASPHALT BINDER, AND MODIFIER (WHERE SPECIFIED) MEETING OHIO DEPARTMENT OF TRANSPORTATION (ODOT) REQUIREMENTS. PRIOR TO PRODUCING HOT MIX ASPHALT FOR THIS CONTRACT, THE CONTRACTOR SHALL SUBMIT TO THE ENGINEER FOR APPROVAL, A JOB MIX FORMULA (JMF) OR BITUMINOUS CONCRETE DATA SHEET.

THE JMF SHALL INCLUDE THE MIX TYPE PROPOSED FOR USE, AGGREGATE TYPE AND GRADATION, DESCRIPTION AND SOURCE OF MODIFIER (IF APPLICABLE), AND UNIT WEIGHT OF THE MIXTURE. THE JMF, OR DATA SHEET, SHALL HAVE PREVIOUSLY BEEN APPROVED FOR USE ON ODOT WORK.

FARM DRAINS

ALL FARM DRAINS WHICH ARE ENCOUNTERED DURING CONSTRUCTION WILL EITHER BE REPAIRED OR PROVIDED WITH UNOBSTRUCTED OUTLETS.

EXISTING COLLECTORS AND ISOLATED FARM DRAINS WHICH ARE ENCOUNTERED ABOVE THE ELEVATION OF ROADWAY DITCHES SHALL BE OUTLETED INTO THE ROADWAY DITCH BY ITEM 611 CONDUIT, TYPE F. THE OPTIMUM OUTLET, INVERT ELEVATION SHALL BE ONE FOOT ABOVE THE FLOWLINE ELEVATION OF THE DITCH. LATERAL FIELD TILES WHICH CROSS INTO THE LIMITS OF CONSTRUCTION SHALL BE INTERCEPTED BY ITEM 611 CONDUIT, TYPE F AND CARRIED IN A LONGITUDINAL DIRECTION TO AN ADEQUATE OUTLET OR ROADWAY CROSSING.

THE LOCATION, TYPE, SIZE AND GRADE OR REPLACEMENTS SHALL BE DETERMINED BY THE ENGINEER AND PAYMENT SHALL BE MADE ON FINAL MEASUREMENT.

EROSION CONTROL PADS AND ANIMAL GUARDS SHALL BE PROVIDED AT THE OUTLET AND OF ALL FARM DRAINS AS PER STANDARD CONSTRUCTION DRAWING DM-1.1 EXCEPT WHEN THEY OUTLET INTO A DRAINAGE STRUCTURE. PAYMENT FOR THE EROSION CONTROL PADS AND ANIMAL GUARDS AND ANY NECESSARY BENDS, TEES OR OTHER FITTINGS SHALL B INCLUDED FOR PAYMENT IN THE PERTINENT CONDUIT ITEMS.

THE FOLLOWING CONTINGENCY QUANTITIES HAVE BEEN INCLUDED IN THE GENERAL SUMMARY FOR THE WORK NOTED ABOVE TO BE USED AS DIRECTED BY THE ENGINEER.

ITEM 611 - 4" CONDUIT, TYPE F	50 FT.
ITEM 611 - 6" CONDUIT, TYPE F	50 FT.

ITEM 832 - TEMPORARY SOIL EROSION AND SEDIMENT CONTROL

THE FOLLOWING ESTIMATED QUANTITIES ARE TO BE PLACED BY THE CONTRACTOR WITH THE ENGINEERS CONCURRENCE FOR TEMPORARY EROSION AND SEDIMENT CONTROL MEASURES.

ITEM 832 - PERIMETER, DITCH CHECK OR INLET PROTECTION FILTER FABRIC FENCE	300 FT.
---	---------

ITEM 614 - MAINTAINING TRAFFIC

NOTICE OF CLOSURE SIGNS, SHALL BE ERECTED BY THE ENGINEER IN ADVANCE OF THE SCHEDULE ROAD CLOSURE. THE CONTRACTOR SHALL GIVE AT LEAST A TWO WEEK NOTICE TO THE ENGINEER IN ORDER TO ERECT THESE SIGNS.

THE CONTRACTOR SHALL PROVIDE, ERECT AND MAINTAIN STANDARD 48" x 30" "ROAD CLOSED" SIGNS, SIGN SUPPORTS, BARRICADES, GATES, AND LIGHTS, AS DETAILED IN STANDARD CONSTRUCTION DRAWING MT-101.60 DURING PERIODS IN WHICH THE AFFECTED ROADS ARE CLOSED TO TRAFFIC.

ACCESS TO LOCAL PROPERTY OWNERS SHALL BE MAINTAINED AT ALL TIMES.

ALL WORK AND TRAFFIC CONTROL DEVICES SHALL BE IN ACCORDANCE WITH 614 AND OTHER APPLICABLE PORTIONS OF THE SPECIFICATIONS, AS WELL AS THE OHIO MANUAL OF UNIFORM TRAFFIC CONTROL DEVICES. PAYMENT FOR ALL LABOR, EQUIPMENT AND MATERIALS SHALL BE INCLUDED IN THE LUMP SUM CONTRACT PRICE FOR 614, MAINTAINING TRAFFIC, UNLESS SEPARATELY ITEMIZED IN THE PLANS.

DESIGN AGENCY

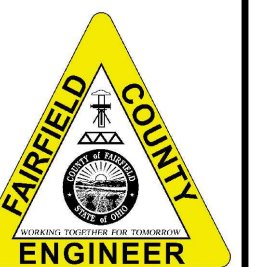

DESIGNER

JAA

REVIEWER

WGM 01/25

PROJECT ID

TR289-0.132

SHEET TOTAL

3 17

SHEET NUM.								PART.	ITEM	ITEM EXT	GRAND TOTAL	UNIT	DESCRIPTION	SEE SHEET NO.
OFF CALC.		3		5										
													ROADWAY	
								201	11000	LS			CLEARING AND GRUBBING	
				441				202	23000	441	SY		PAVEMENT REMOVED	
				153				202	35100	153	FT		PIPE REMOVED, 24" AND UNDER	
				1,168				203	10000	1,168	CY		EXCAVATION	
				296				203	20000	296	CY		EMBANKMENT	
				678				204	10000	678	SY		SUBGRADE COMPACTION	
	100							204	13000	100	CY		EXCAVATION OF SUBGRADE	
	100							204	30051	100	CY		GRANULAR MATERIAL, TYPE F, AS PER PLAN	3
	1							204	45000	1	HOUR		PROOF ROLLING	
	200							204	50000	200	SY		GEOTEXTILE FABRIC	
													EROSION CONTROL	
				1,759				659	10000	1,759	SY		SEEDING AND MULCHING	
				0.16				659	20000	0.16	TON		COMMERCIAL FERTILIZER	
				0.36				659	31000	0.36	ACRE		LIME	
				10				659	35000	10	MGAL		WATER	
				343				670	00720	343	SY		DITCH EROSION PROTECTION MAT, TYPE B	
	300							SPECIAL	69098100	300	FT		EROSION CONTROL (PERIMETER FILTER FABRIC FENCE)	
													DRAINAGE	
	50							611	00406	50	FT		4" CONDUIT, TYPE F	
	50							611	01500	50	FT		6" CONDUIT, TYPE F	
				144				611	04900	144	FT		12" CONDUIT, TYPE D, 706.02	
													PAVEMENT	
				76				301	56000	76	CY		ASPHALT CONCRETE BASE, PG64-22, (449)	
				81				304	20000	81	CY		AGGREGATE BASE	
				81				304	20000	81	CY		AGGREGATE BASE, (BERM AND DRIVES)	
				70				407	20000	70	GAL		NON-TRACKING TACK COAT FOR INTERMEDIATE COURSE	
				36				407	20000	36	GAL		NON-TRACKING TACK COAT FOR BASE COURSE	
				23				411	10001	23	CY		STABILIZED CRUSHED AGGREGATE, AS PER PLAN	
				4				441	70300	4	CY		ASPHALT CONCRETE INTERMEDIATE COURSE, TYPE 2, (449), (VARIABLE LEVELING COURSE)	
				22				441	70300	22	CY		ASPHALT CONCRETE INTERMEDIATE COURSE, TYPE 2, (449)	
				55				441	70000	55	CY		ASPHALT CONCRETE SURFACE COURSE, TYPE 1, (449), PG64-22	
													MAINTENANCE OF TRAFFIC	
								614	11000	LS			MAINTAINING TRAFFIC	
								623	10000	LS			CONSTRUCTION LAYOUT STAKES AND SURVEYING	
								624	10000	LS			MOBILIZATION	

GENERAL SUMMARY



DESIGN AGENCY
 DESIGNER
 JAA
 REVIEWER
 WGM 01/25
 PROJECT ID
 TR289-0.132
 SHEET TOTAL
 4 17

REF. NO.	SHEET NO.	STATION TO STATION	SIDE	202	202	611	670								
				PAVEMENT REMOVED SY	PIPE REMOVED, 24" AND UNDER FT	12" CONDUIT, TYPE D, 706.02 FT	DITCH EROSION CONTROL MAT, TYPE B SY								
R1	7	19+92 TO 20+22	RT		30										
R2	7	22+42 TO 22+72	RT		30										
R3	7	22+93 TO 23+23	RT		30										
R4	8	24+00 TO 24+63	RT		63										
R5	8	24+00 TO 26+20	LT & RT	441											
D1	7	19+95 TO 20+25	RT			32									
D2	7	22+45 TO 23+25	RT			80									
D3	8	24+33 TO 24+63	RT			32									
E1	7	19+39 TO 19+94	RT				52								
E2	7	20+25 TO 22+45	RT				196								
E3	7&8	23+25 TO 24+32	RT				95								
TOTALS CARRIED TO GENERAL SUMMARY				441	153	144	343	0	0	0	0	0	0	0	0

SUBSUMMARY/PAVEMENT CALCULATIONS

ITEM 441 - ASPHALT CONCRETE SURFACE COURSE, TYPE 1 (449), PG64-22

STA.19+20 TO STA.19+50 (18'x30')x 0.625"/12/ 27 = 1 CY
 STA.19+50 TO STA.25+90 (18'x640')x 1.50"/12/ 27 = 53 CY
 STA.25+90 TO STA.26+20 (18'x30')x 0.625"/12/ 27 = 1 CY
 55 CY TOTAL

ITEM 441 - VARIABLE ASPHALT CONCRETE INTERMEDIATE LEVELING COURSE, TYPE 2 (449)

STA.23+15 TO STA.24+00 LT(9'x85')x 1.50"/12/ 27 = 4 CY

ITEM 441 - ASPHALT CONCRETE INTERMEDIATE COURSE, TYPE 2 (449)

STA.24+00 TO STA.26+20 (18'x220')x 1.75"/12/ 27 = 22 CY

ITEM 301 - ASPHALT CONCRETE BASE

STA.24+00 TO STA.26+20 (18.67'x220')x 6"/12/ 27 = 76 CY

ITEM 304 - AGGREGATE BASE

STA.24+00 TO STA.26+20 (19.67'x220')x 6"/12/ 27 = 81 CY

ITEM 304 - AGGREGATE BASE (BERM & DRIVES)

STA.19+20 RT TO STA.25+90 RT(2'x670')x 6"/12/ 27 = 25 CY
 STA.23+15 LT TO STA.26+15 LT(2'x300')x 6"/12/ 27 = 11 CY
 STA.25+90 RT TO STA.26+20 RT(1.4'x30')x 6"/12/ 27 = 1 CY
 STA.26+15 LT TO STA.26+20 LT(1.6'x5')x 6"/12/ 27 = 1 CY
 DRIVES (DR1)11+(DR2)10+(DR3)12+(DR4)10 = 43 CY
 81 CY TOTAL

ITEM 407 NON-TRACKING TACK COAT (BASE COURSE)

(220'x19.67' = 7278 SF)/9 x 0.075 = 36 GAL.

ITEM 407 NON-TRACKING TACK COAT (INTERMEDIATE COURSE)

(700'x18' = 12600 SF)/9 x 0.050 = 70 GAL.

ITEM 411 STABILIZED CRUSHED AGGREGATE, AS PER PLAN

STA.19+20 LT TO STA.23+15 LT(0.75'x395')x 3"/12/ 27 = 3 CY
 STA.19+20 RT TO STA.25+90 RT(2'x670')x 3"/12/ 27 = 12 CY
 STA.23+15 LT TO STA.26+15 LT(2'x300')x 3"/12/ 27 = 6 CY
 STA.25+90 RT TO STA.26+20 RT(1.4'x30')x 3"/12/ 27 = 1 CY
 STA.26+15 LT TO STA.26+20 LT(1.6'x5')x 3"/12/ 27 = 1 CY
 23 CY TOTAL

ITEM 203 EXCAVATION

PER CROSS SECTION SHEETS
 (10+63+247+173+70+263+167+175+0) = 1168 CY

ITEM 203 EMBANKMENT

PER CROSS SECTION SHEETS
 (2+3+3+3+32+95+115+43+0) = 296 CY

ITEM 204 SUBGRADE COMPACTION

(220'x19.67' = 4327 SF)/9 = 481 SY
 DRIVES (DR1)50+(DR2)47+(DR3)53+(DR4)47 = 197 SY
 678 SY TOTAL

ITEM 659 SEEDING AND MULCHING

PER CROSS SECTION SHEETS
 (0+231+298+511+0+300+250+169+0) = 1759 SY

ITEM 659 COMMERCIAL FERTILIZER

15831 SF x (20 / 1000 SF) X (1 TON / 2000) = 0.158 TON

ITEM 659 LIME

15831 SF x (1 SF/43560 AC) = 0.36 AC.

ITEM 659 WATER

15831 SF x (300 GAL / 1000 SF) x (1 MGAL/1000 GAL) x 2 = 10 MGAL

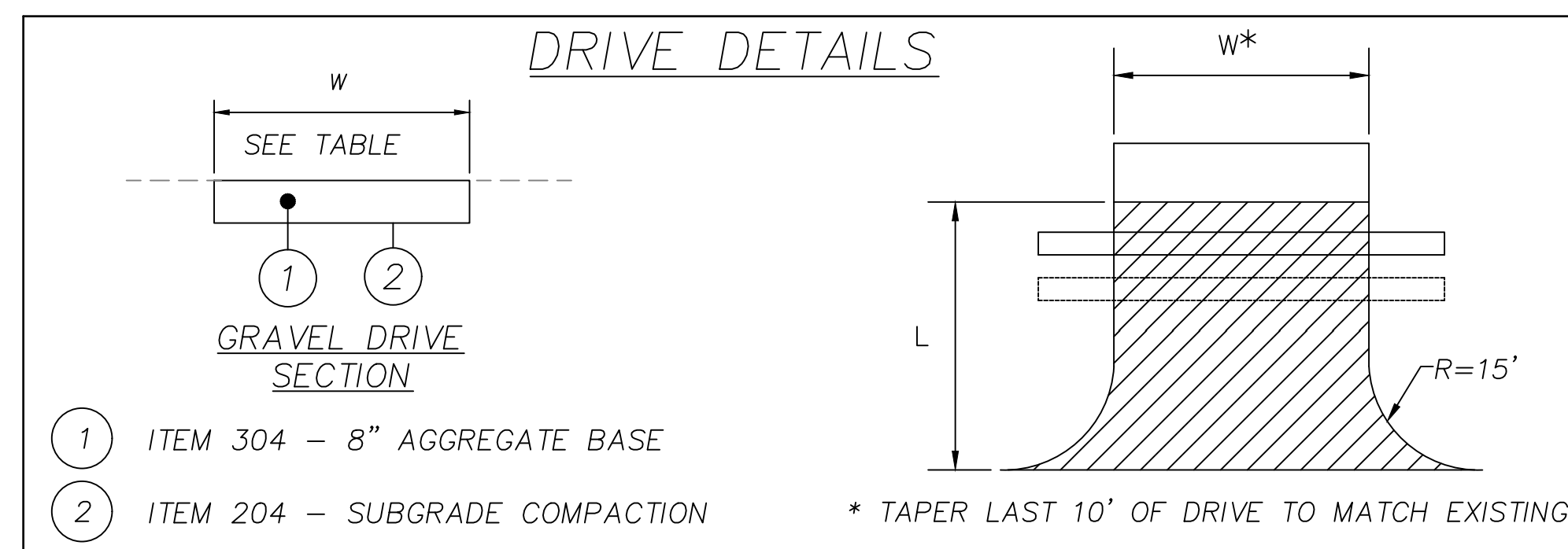

DRIVE QUANTITIES				ITEM 204	ITEM 304
STA. & C	SIDE	(L)	(W)	SQ.YD.	CU.YD.
20+04	RT.	30'	15'	50	11
22+60	RT.	30'	14'	47	10
23+10	RT.	34'	14'	53	12
24+48	RT.	30'	14'	47	10
TOTAL FOR GENERAL SUMMARY				197	43

DESIGN AGENCY

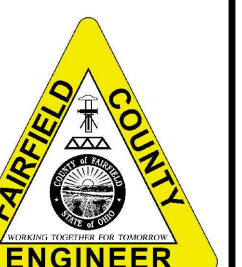

DESIGNER
JAA
REVIEWER

WGM 01/25

PROJECT ID

TR289-0.132

SHEET TOTAL
5 17

- (X) CODED NOTES**
 1 Ex. Mailbox (DND)

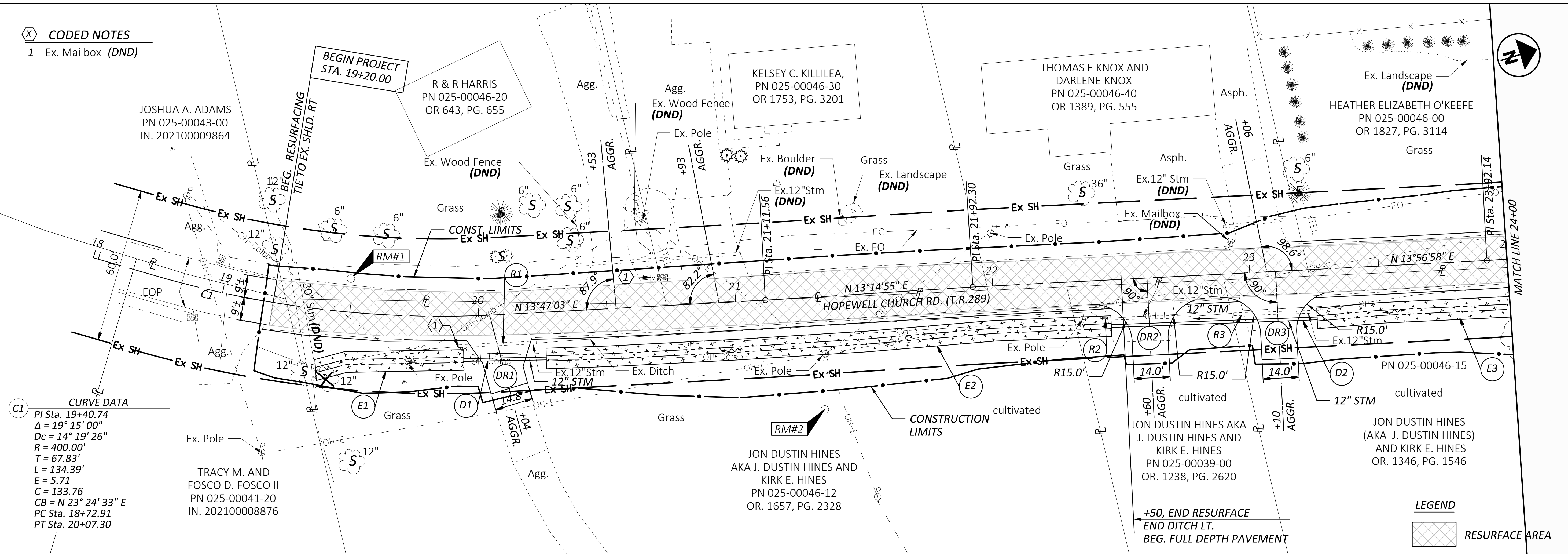

C1 CURVE DATA
 PI Sta. 19+40.74
 $\Delta = 19^\circ 15' 00''$
 $Dc = 14^\circ 19' 26''$
 $R = 400.00'$
 $T = 67.83'$
 $L = 134.39'$
 $E = 5.71$
 $C = 133.76$
 $CB = N 23^\circ 24' 33'' E$
 PC Sta. 18+72.91
 PT Sta. 20+07.30

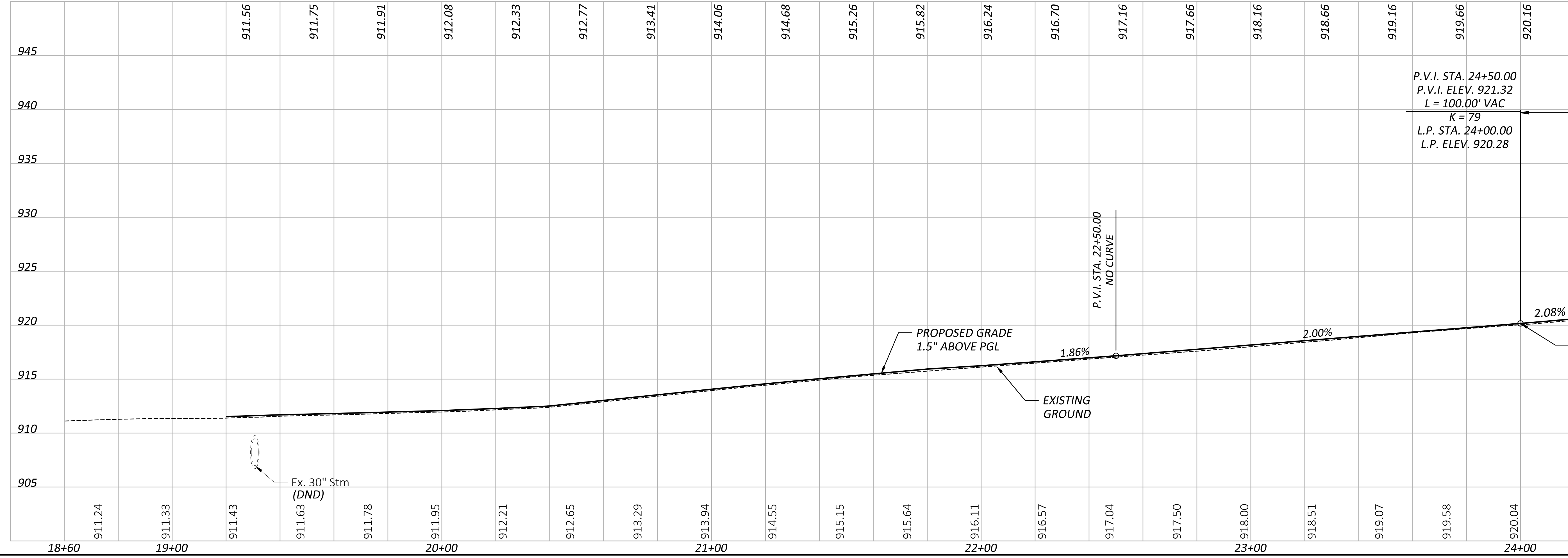

PLAN AND PROFILE
 STA. 18+75.00 TO STA. 24+00.00
 (TR289-HOPEWELL CHURCH ROAD)

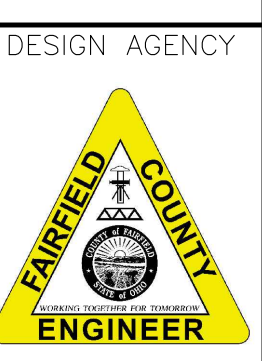

DESIGN AGENCY	FAIRFIELD COUNTY ENGINEER
DESIGNER	JAA
REVIEWER	WGM
PROJECT ID	TR289-0.132
SHEET	6
TOTAL	17

FAI-TR289-0.132

J:\Township\Madison\Hopewell Church Road\TR289 Ditch Project 2024\Design\Plans\Sheets\TR289_GP001.dwg 06-Feb-25 10:13 AM

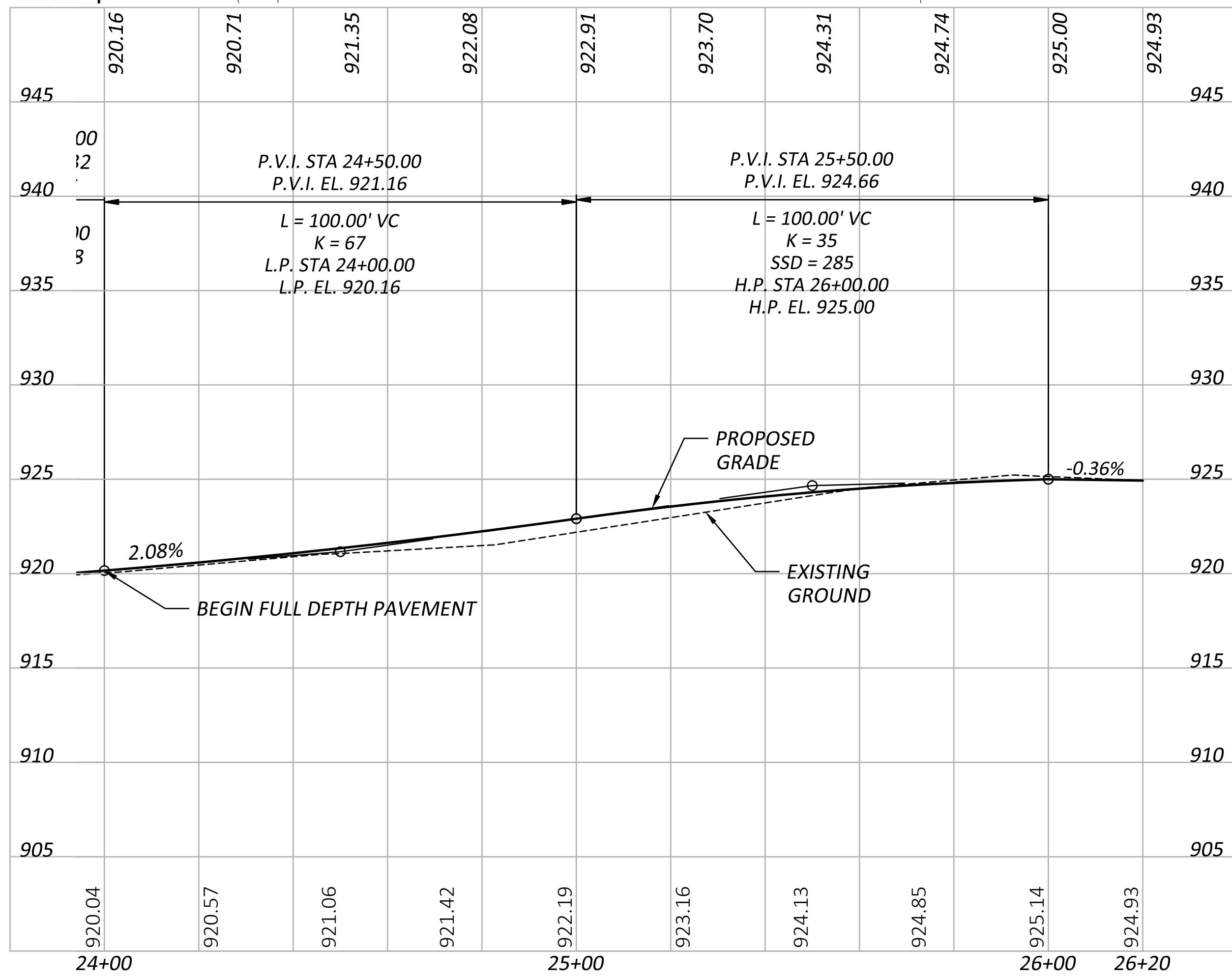
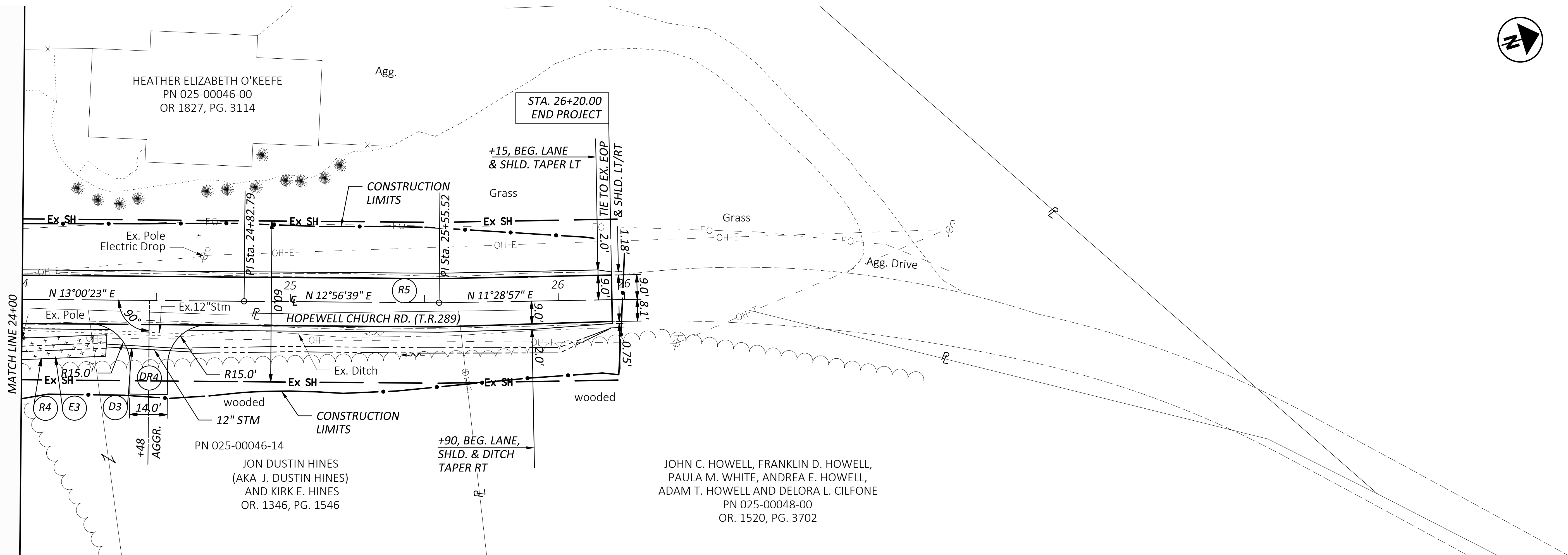

PLAN AND PROFILE
 STA. 24+00.00 TO STA. 26+24.04
 (TR289-HOPEWELL CHURCH ROAD)

DESIGN AGENCY

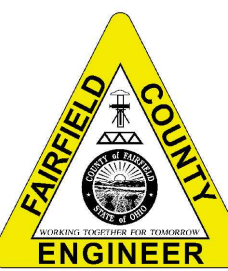

DESIGNER	JAA
REVIEWER	
PROJECT ID	WGM 01/25
TR289-0.132	
SHEET	TOTAL
7	17

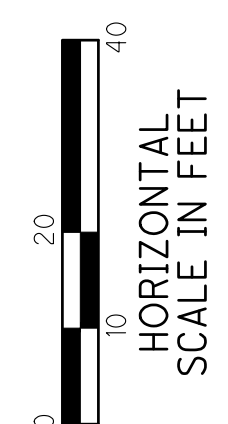
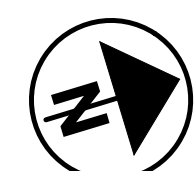

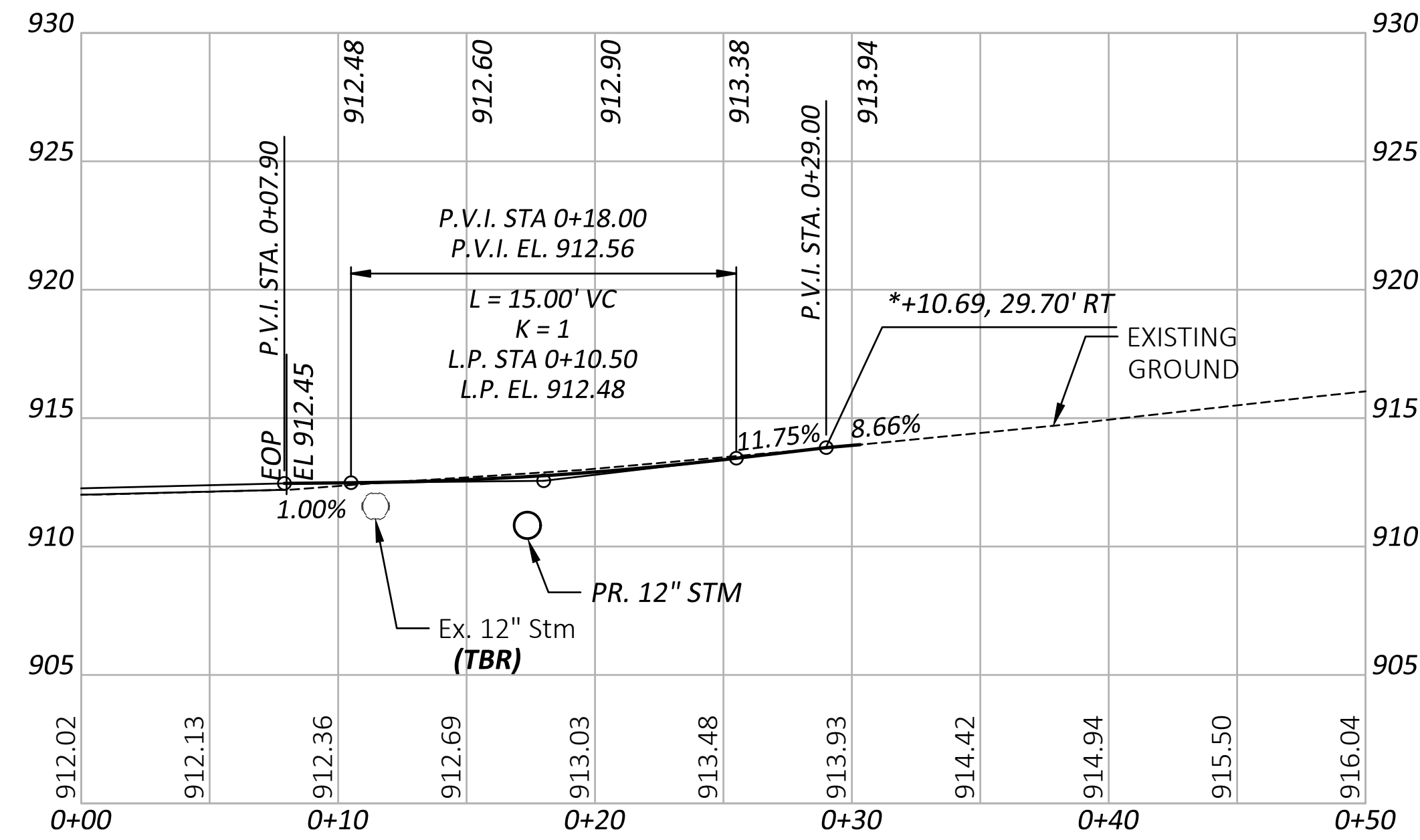
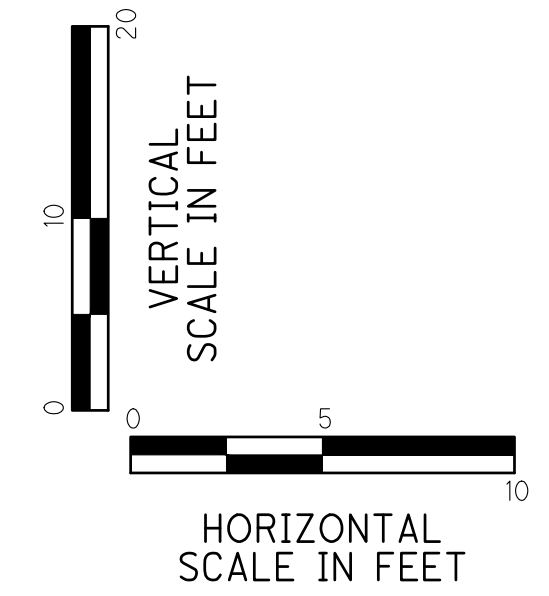

DRIVE 1 PROFILE

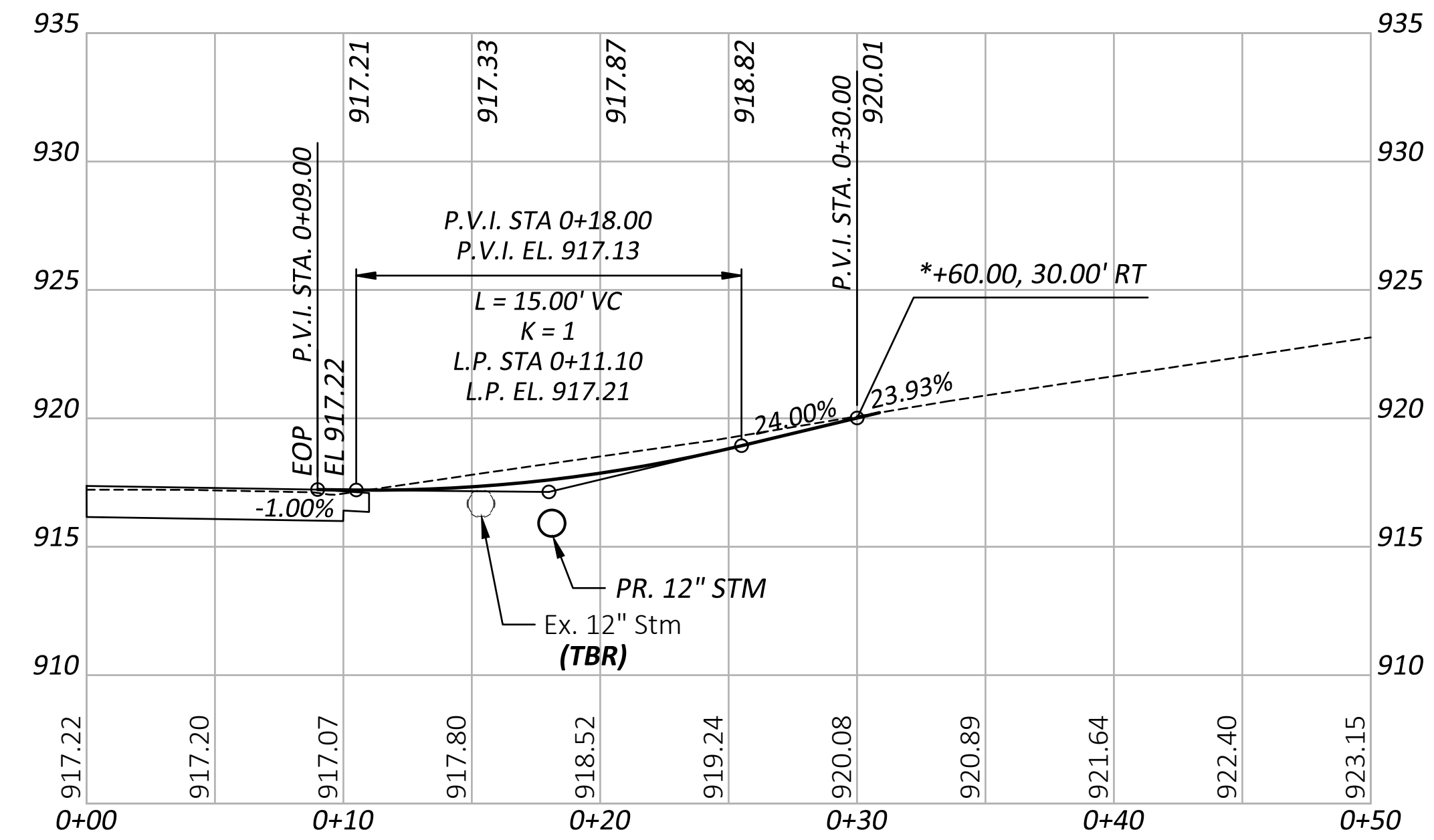

DRIVE 2 PROFILE

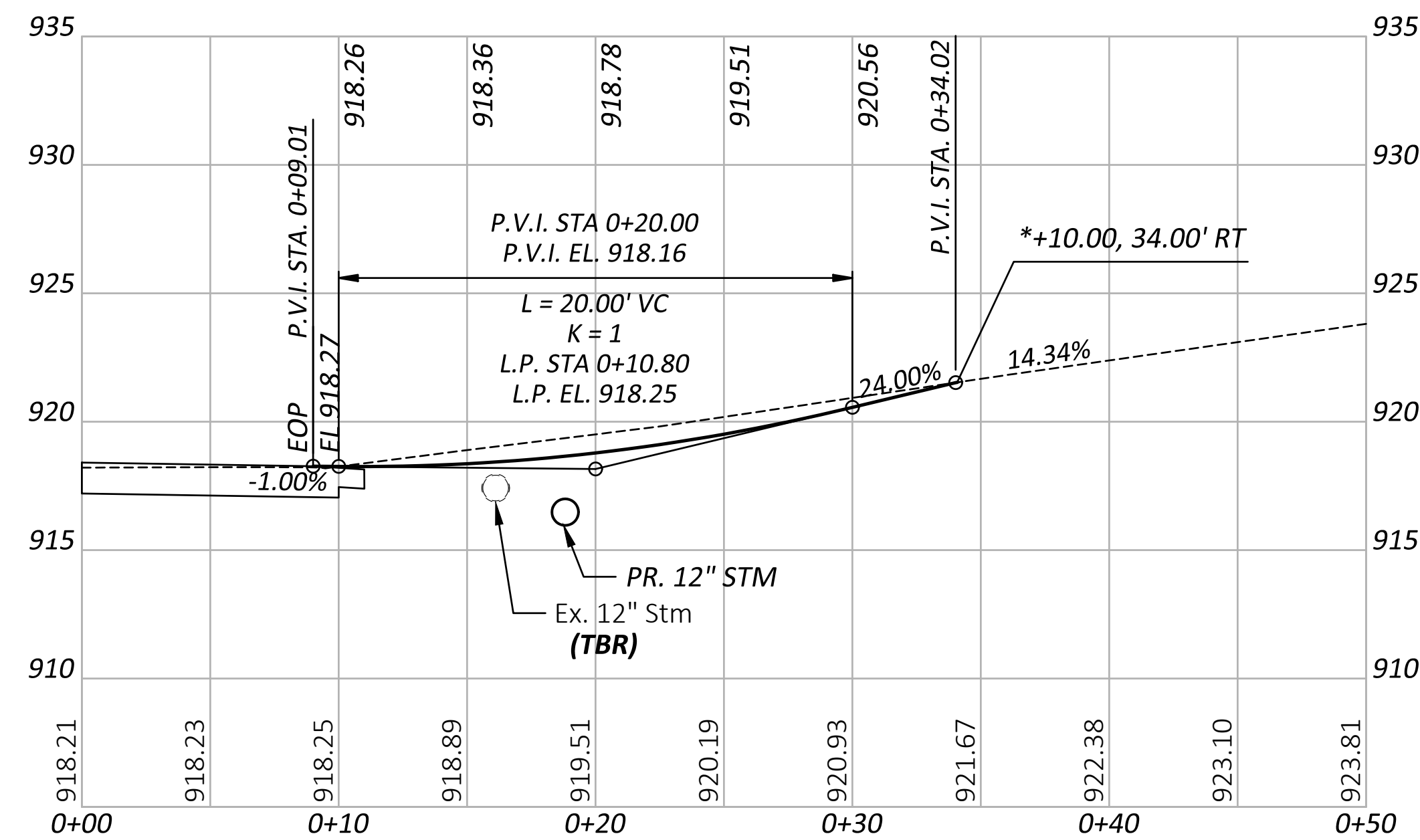

DRIVE 3 PROFILE

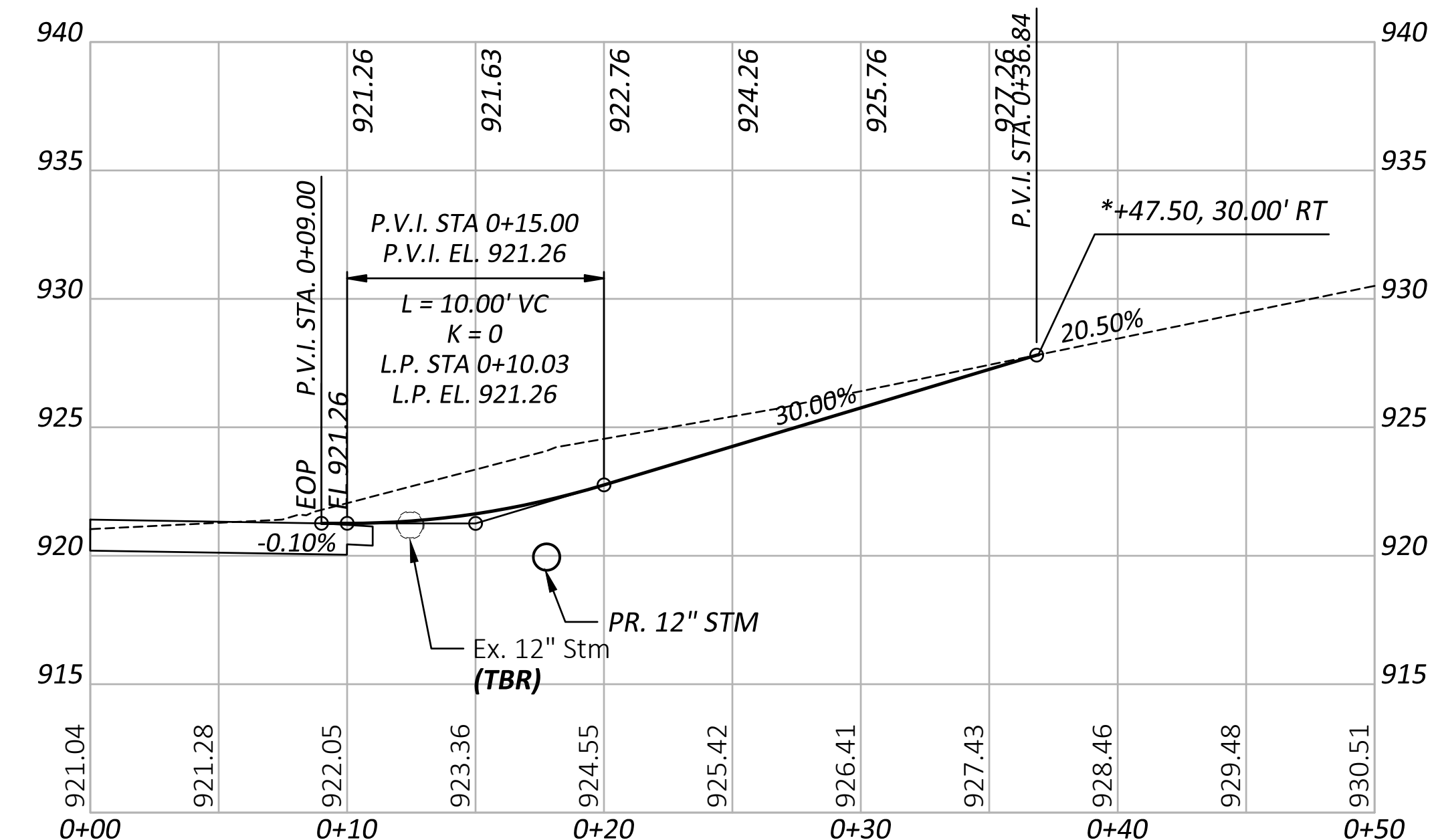

DRIVE 4 PROFILE

Note:
 * ∇ HOPEWELL CHURCH RD. STATION AND OFFSET.

DRIVE DETAILS

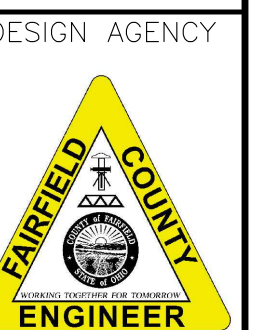

DESIGN AGENCY	
DESIGNER	JAA
REVIEWER	
PROJECT ID	WGM 01/25
SHEET	TR289-0.132
TOTAL	8 / 17

SEEDING	
END WIDTH	SO. YDS.
0	0

END AREA		VOLUME	
CUT	FILL	CUT	FILL
0	0	10	2
TOTAL		10	2

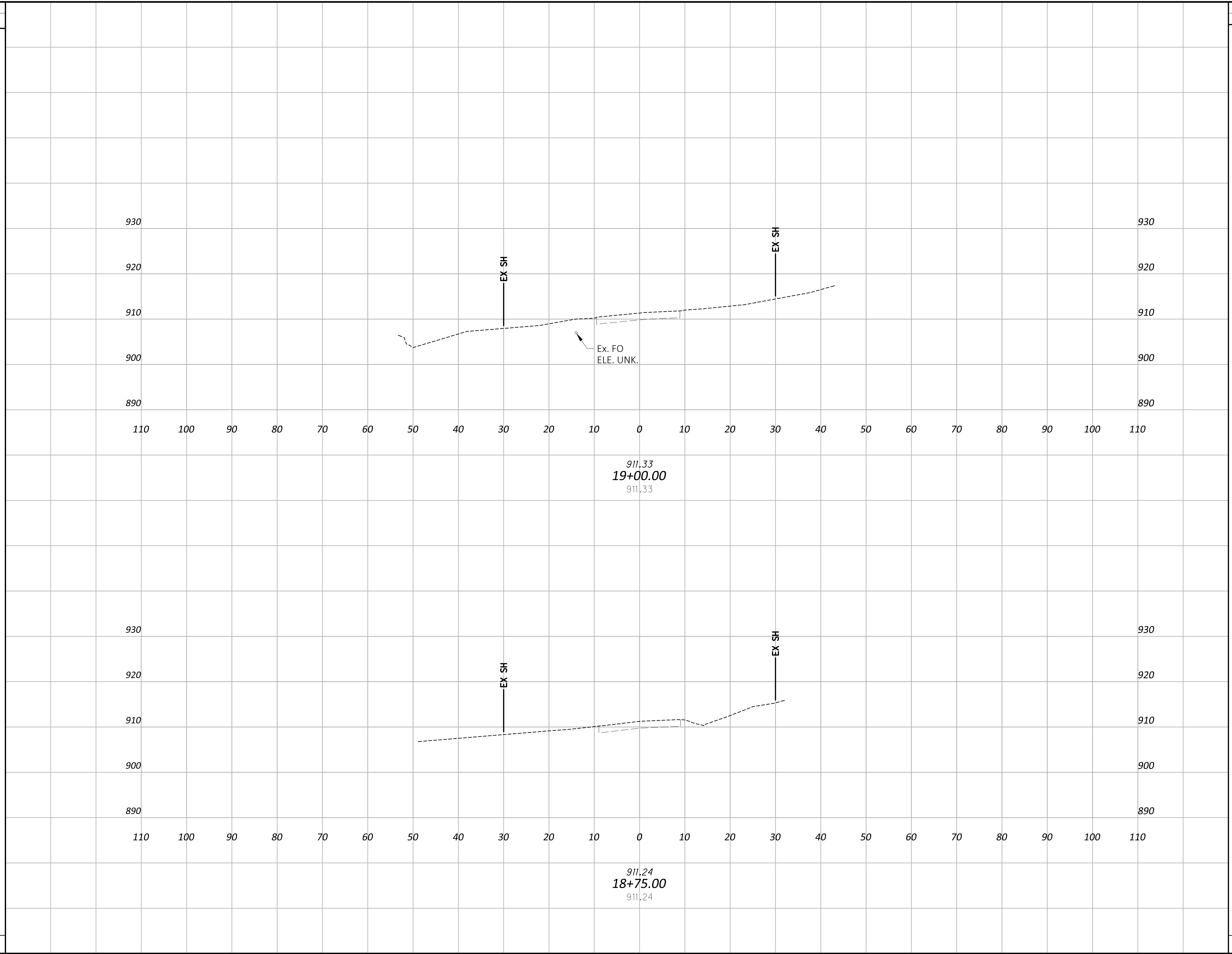

**CROSS SECTIONS - T.R. 289 (HOPEWELL CHURCH ROAD)
STA. 18+75.00 TO STA. 19+00.00**

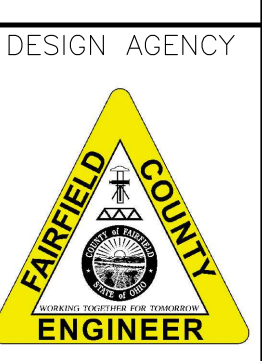

DESIGN AGENCY	
DESIGNER	JAA
REVIEWER	
PROJECT ID	WGM 01/25
SHEET	9
TOTAL	17

SEEDING	
END WIDTH	SO. YDS.

117

20

114

21

231

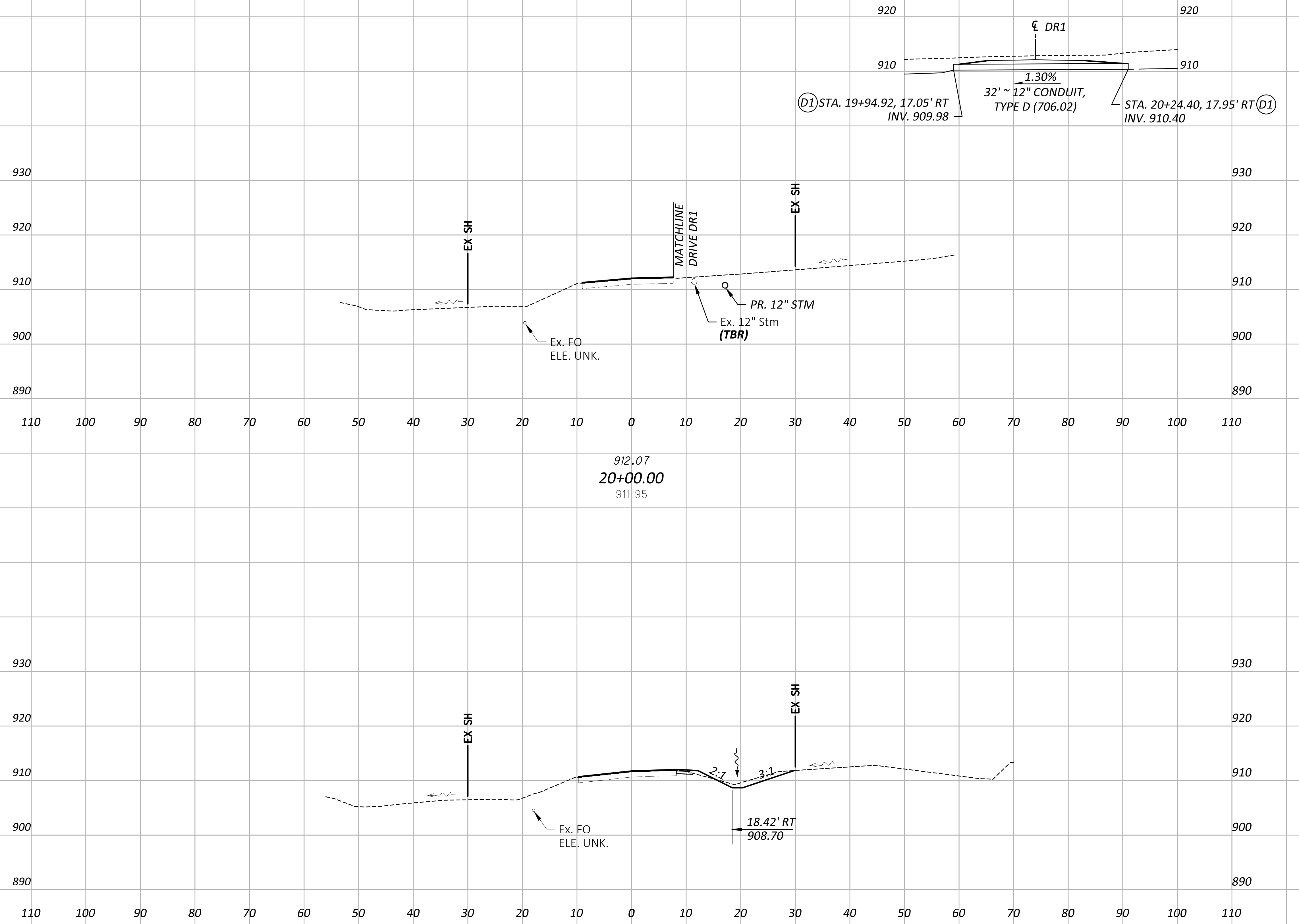

END AREA		VOLUME	
CUT	FILL	CUT	FILL

49 1

7 0

17 2

11 2

TOTAL 63 3

CROSS SECTIONS - T.R. 289 (HOPEWELL CHURCH ROAD)
STA. 19+50.00 TO STA. 20+00.00

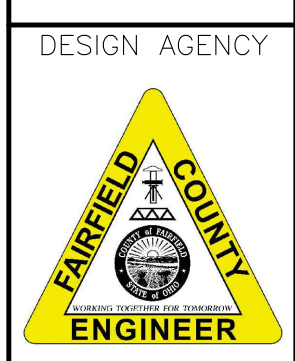

DESIGN AGENCY	
DESIGNER	JAA
REVIEWER	
PROJECT ID	WGM 01/25
SHEET	TR289-0.132
TOTAL	10 17

SEEDING
END SO.
WIDTH YDS.

156

29

142

22

298

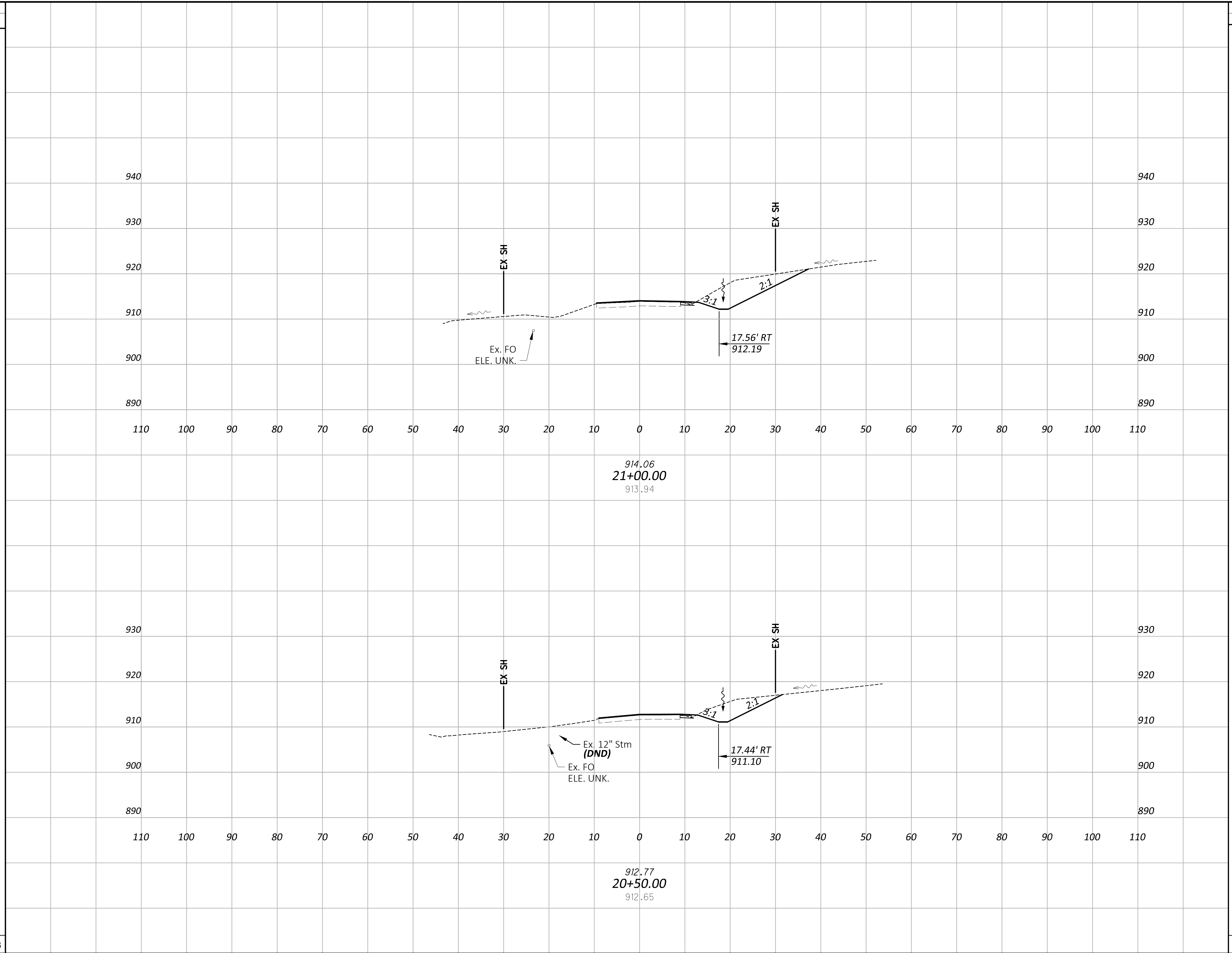

END	AREA		VOLUME	
	CUT	FILL	CUT	FILL
156			133	1
29	77	1		
142			114	2
22	46	1		
TOTAL			247	3

**CROSS SECTIONS - T.R. 289 (HOPEWELL CHURCH ROAD)
STA. 20+50.00 TO STA. 21+00.00**

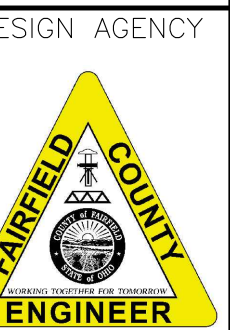

DESIGN AGENCY
DESIGNER
JAA
REVIEWER
WGM 01/25
PROJECT ID
TR289-0.132
SHEET TOTAL
11 17

SEEDING
END SO.
WIDTH YDS.

375

22

136

27

511

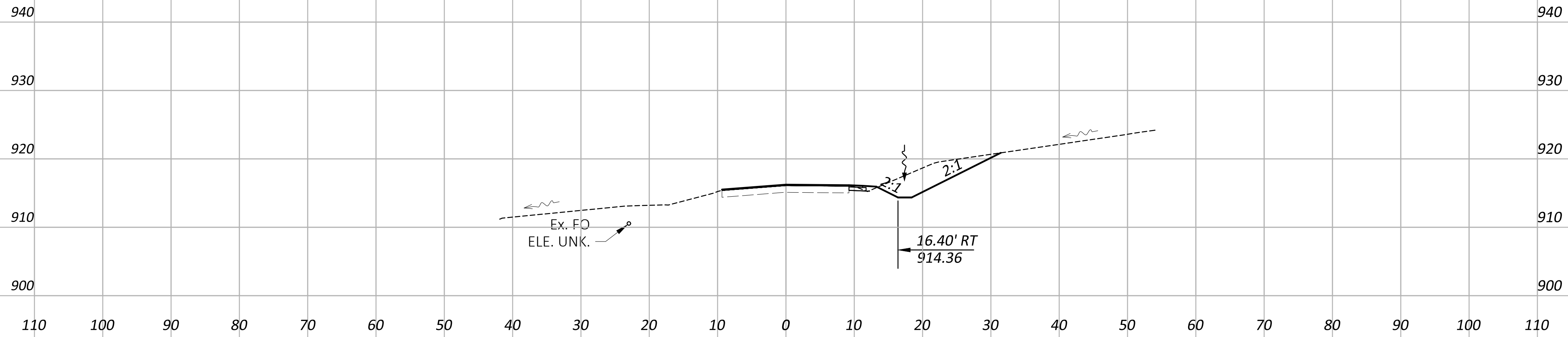

916.36
22+00.00
916.24

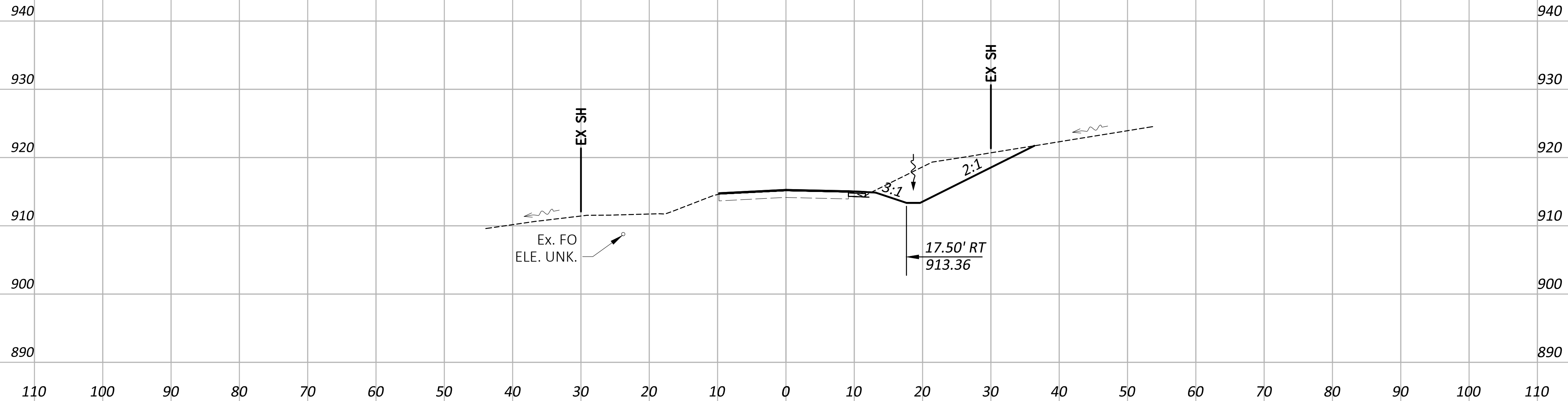

915.26
21+50.00
915.15

STA. 22+50 BACK

END	AREA		VOLUME	
	CUT	FILL	CUT	FILL
40	1			
40	1			
74		2		
40	1			
99		1		
67	0			
TOTAL			173	3

CROSS SECTIONS - T.R. 289 (HOPEWELL CHURCH ROAD)
STA. 21+50.00 TO STA. 22+00.00



DESIGN AGENCY
DESIGNER
JAA
REVIEWER
WGM 01/25
PROJECT ID
TR289-0.132
SHEET TOTAL
12 17

SEEDING	
END WIDTH	SO. YDS.

156

29

144

23

300

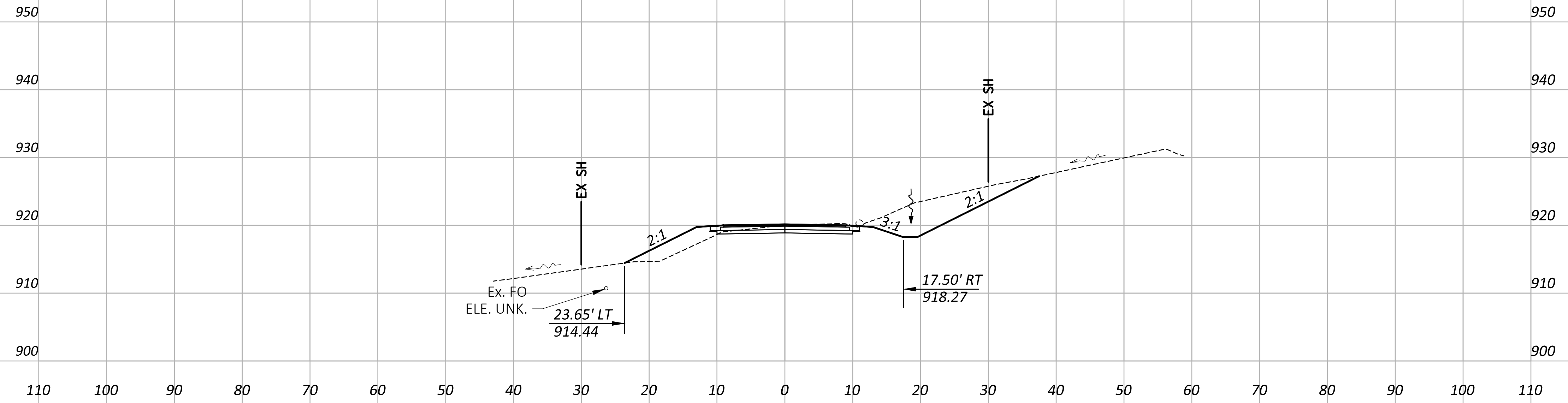

920.16
24+00.00
920.04

BEGIN FULL DEPTH PAVEMENT
STA. 24+00.00

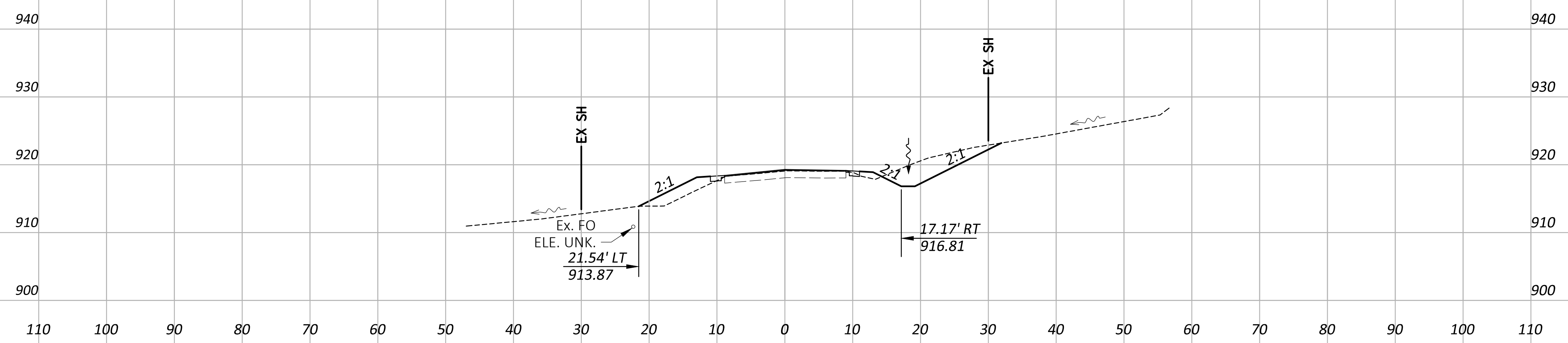

919.16
23+50.00
919.07

END	AREA		VOLUME	
	CUT	FILL	CUT	FILL
156			127	49
29	90	24		
144			136	46
23	57	26		
300				
TOTAL			263	95

CROSS SECTIONS - T.R. 289 (HOPEWELL CHURCH ROAD)
STA. 23+50.00 TO STA. 24+00.00

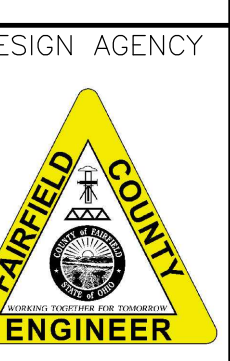

DESIGN AGENCY
DESIGNER
REVIEWER
PROJECT ID
SHEET TOTAL

JAA
WGM 01/25
TR289-0.132
14 17

SEEDING	
END WIDTH	SO. YDS.
117	
21	
133	
27	
250	

117

21

133

27

250

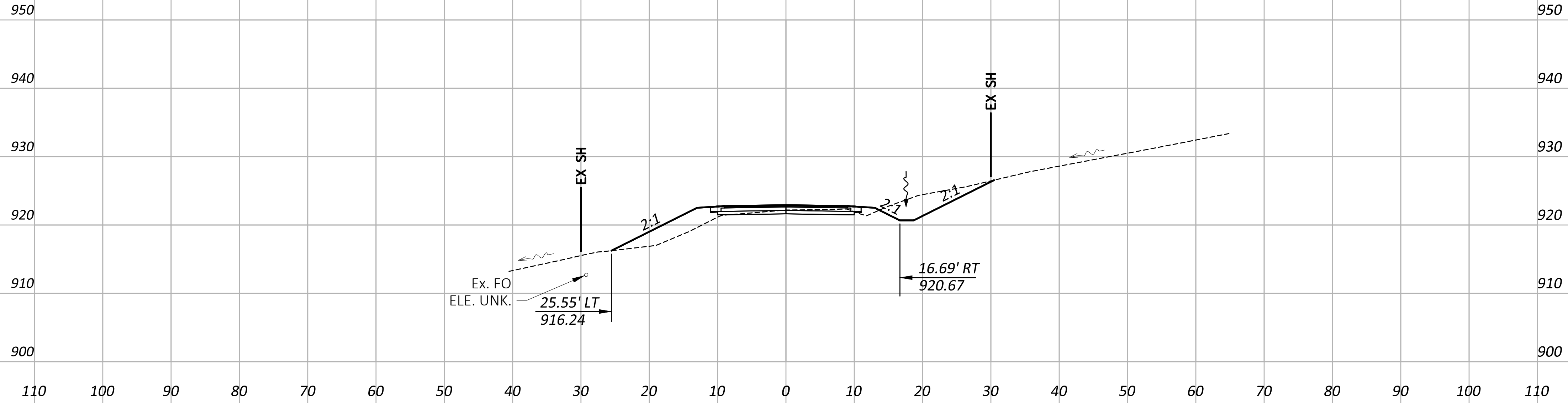

922.91
25+00.00
922.19

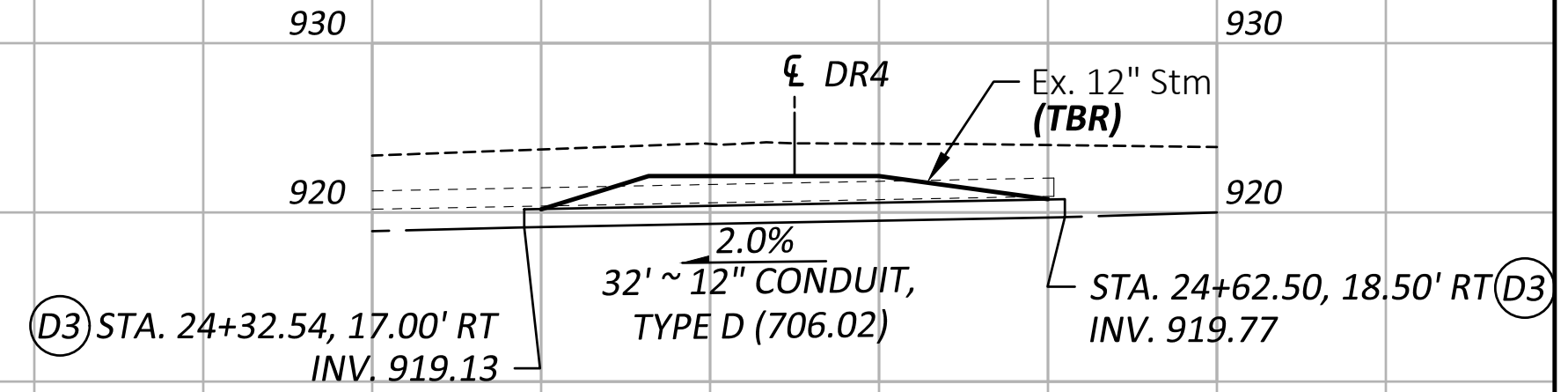

921.35
24+50.00
921.06

END	AREA		VOLUME	
	CUT	FILL	CUT	FILL
117			87	58
21	39	33		
133			80	57
27	47	29		
TOTAL			167	115

**CROSS SECTIONS - T.R. 289 (HOPEWELL CHURCH ROAD)
STA. 24+50.00 TO STA. 25+00.00**

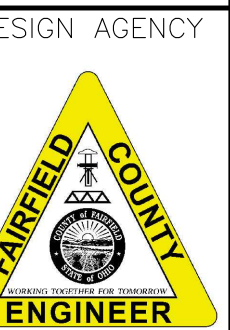

DESIGN AGENCY	
DESIGNER	JAA
REVIEWER	
PROJECT ID	WGM 01/25
SHEET	15
TOTAL	17

SEEDING	END AREA		VOLUME	
	CUT	FILL	CUT	FILL
36			40	8
27	91	8		
133			135	35
21	55	30		
169	TOTAL		175	43

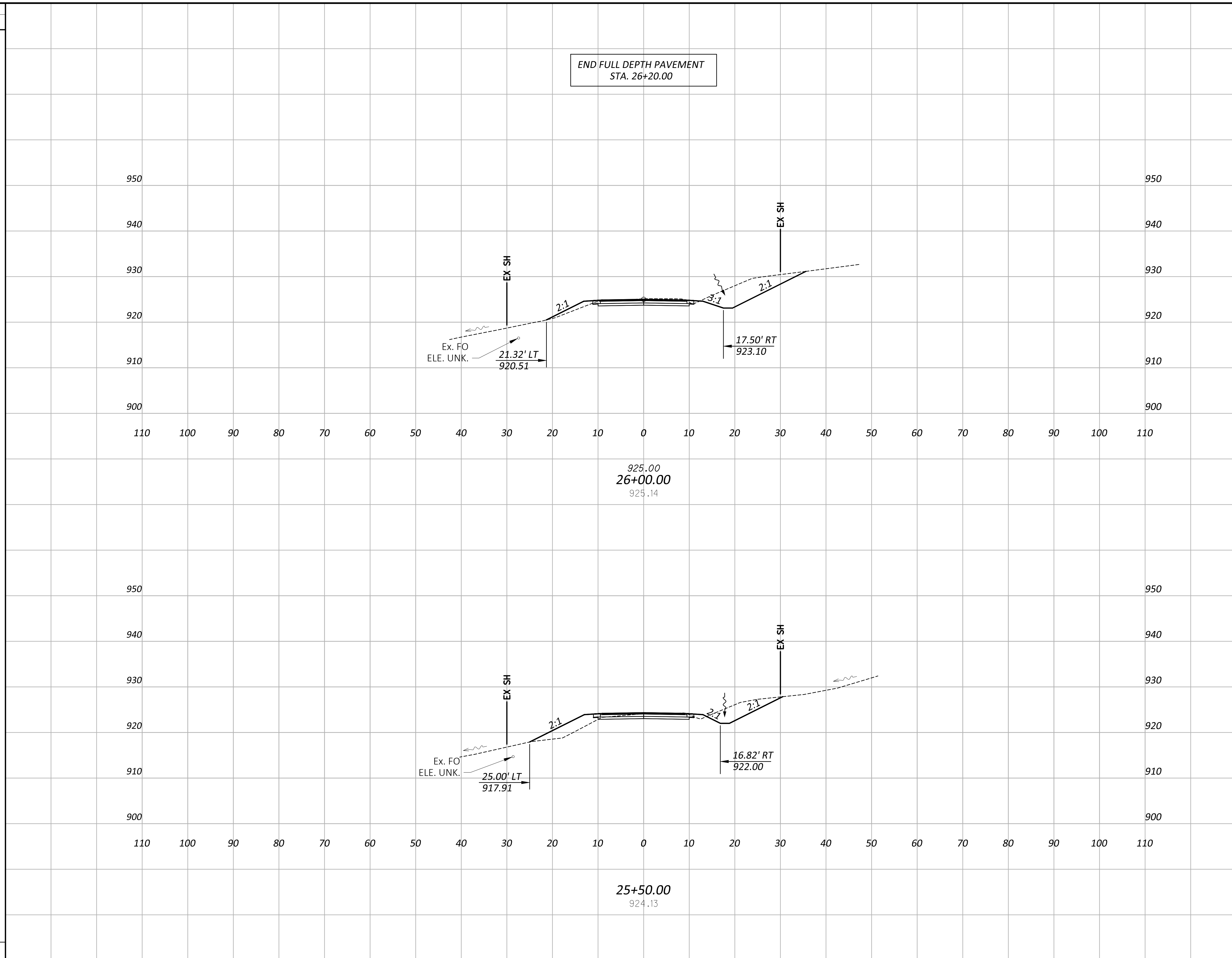

END FULL DEPTH PAVEMENT
STA. 26+20.00

**CROSS SECTIONS - T.R. 289 (HOPEWELL CHURCH ROAD)
STA. 25+50.00 TO STA. 26+00.00**



DESIGNER	JAA
REVIEWER	
PROJECT ID	WGM 01/25
SHEET	16
TOTAL	17

SEEDING	
END WIDTH	SO. YDS.

0	
---	--

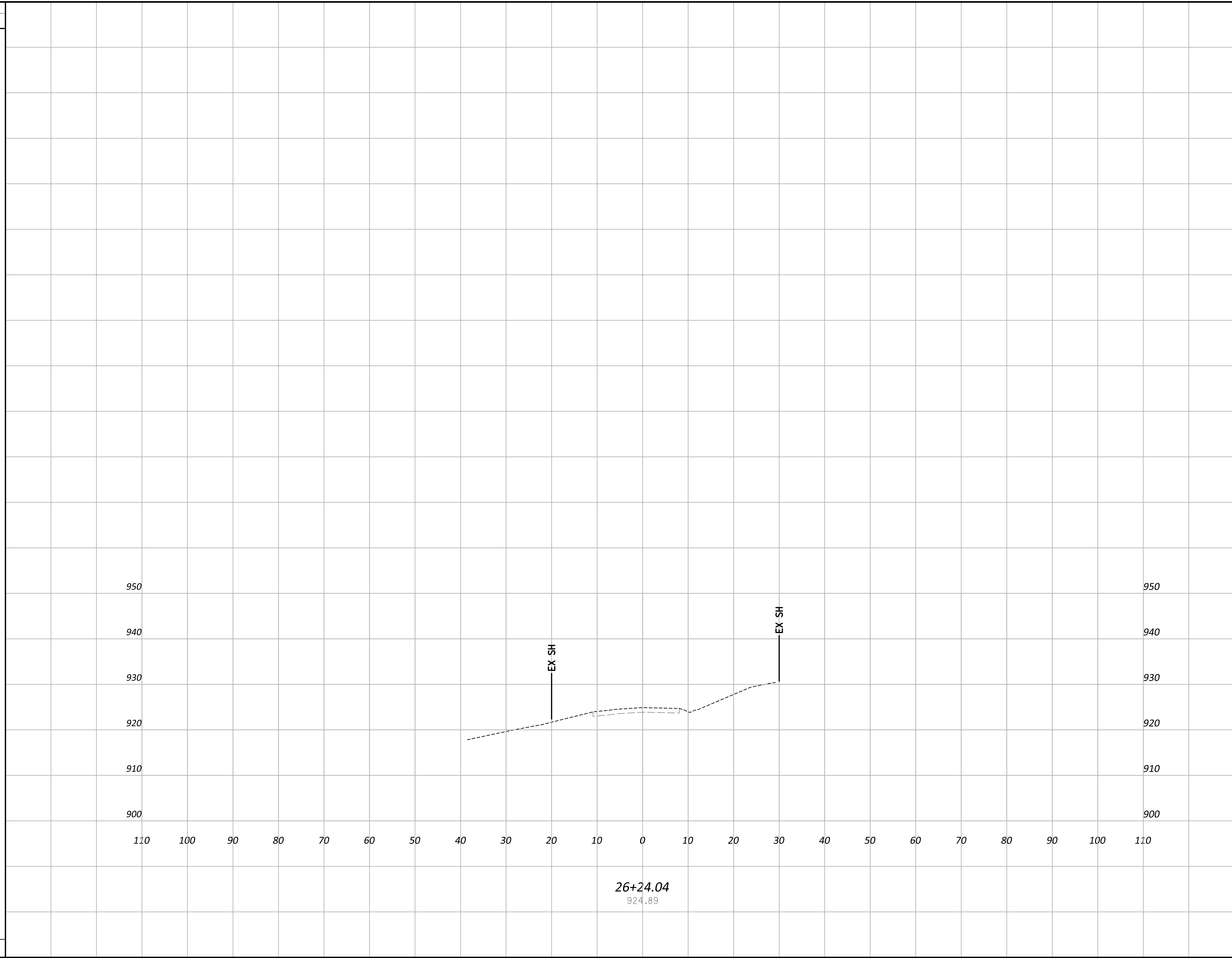

26+24.04
924.89

END CUT	AREA FILL	VOLUME	
		CUT	FILL
0	0	0	0
TOTAL		0	0

**CROSS SECTIONS - T.R. 289 (HOPEWELL CHURCH ROAD)
STA. 26+24.04**



DESIGNER	JAA
REVIEWER	
PROJECT ID	WGM 01/25
SHEET	17
TOTAL	17